

Torch heads DIX MFTZ 5200/5222/5245/5236

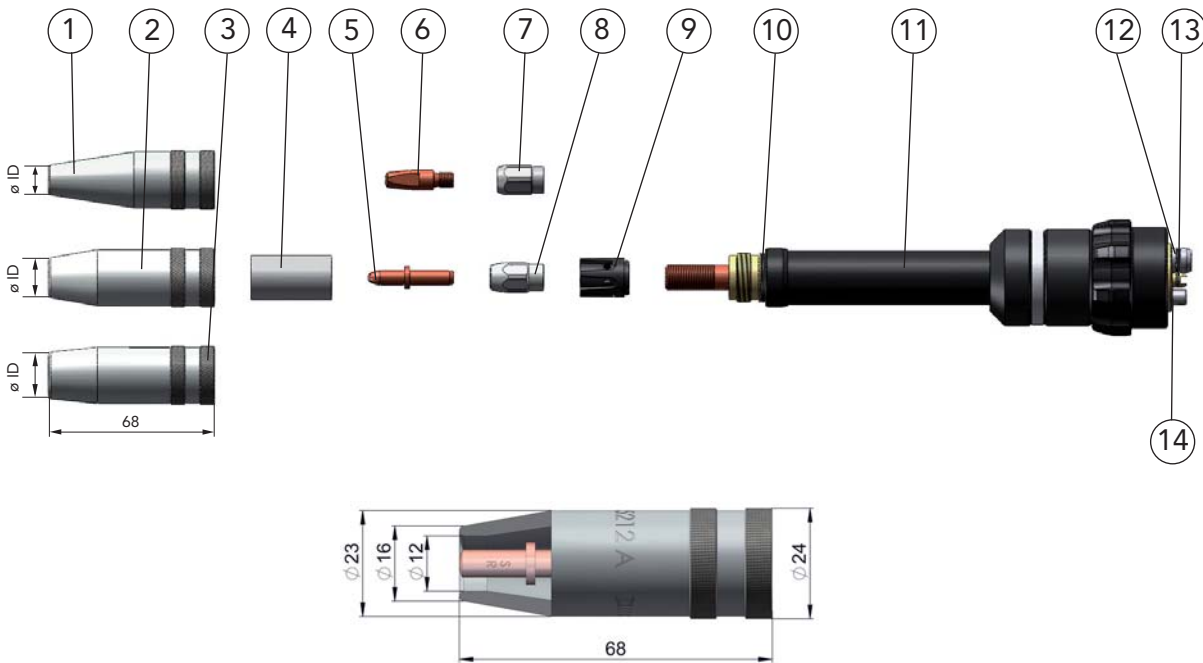

	Description	Dimension	Part name	Part number
1	Gas nozzle	ID \varnothing 9 mm	DIX 1-3-5209 A	6390152090
2	Gas nozzle	ID \varnothing 12 mm	DIX 1-3-5212 A	6390152120
3	Gas nozzle	ID \varnothing 15 mm	DIX 1-3-5215 A	6390152150
4	Insulator For pos. 2 and 3		DIX 2-3-520	6390252000
5	Contact tip	\varnothing 6 x 35 mm	DIX 3-1-__ SR	6190354__
6	Contact tip	M6 x 28 mm	DIX 3-2-__	6290300__
	Contact tip	M6 x 28 mm	DIX 3-2-__ CR-ZR	6290330__
7	Tip adapter		DIX GS 1-K	618150001
8	Clamp nut		DIX 4-1-MAS	6390452000
9	Gas diffusor		DIX 10-1-MAS	6391052000
10	O - ring, 17x1.5 mm	(10 pcs.)		639060002
11	Torch neck	0°	DIX 6-3-5200 MFTZ	6390685200
	Torch neck	22°	DIX 6-3-5222 MFTZ	6390685222
	Torch neck	45°	DIX 6-3-5245 MFTZ	6390685245
	Torch neck	36°	DIX 6-3-5236 MFTZ	6390685236
12	O - ring, 7x1.5 mm	(10 pcs.)		639159009
13	O - ring, 4x1.2 mm	(10 pcs.)		629110903
14	O - ring, 6x1.5 mm	(10 pcs.)		639060008

__ Enter the required wire diameter, e.g.: 08 = 0.8 mm or 10 = 1.0 mm.

