

# BOSTITCH®

## OPERATION and MAINTENANCE MANUAL

MODEL BCAR1B / BCAR-2S STAPLER  
WITH 8" (203.2mm) NOSE

**▲WARNING:**

BEFORE OPERATING THIS TOOL, STUDY THIS MANUAL AND UNDERSTAND THE SAFETY WARNINGS AND INSTRUCTIONS. IF YOU HAVE ANY QUESTIONS, CONTACT YOUR BOSTITCH REPRESENTATIVE OR DISTRIBUTOR. SAVE THESE INSTRUCTIONS FOR FUTURE REFERENCE.

**▲WARNING:**

OPERATOR AND OTHERS IN THE WORK AREA SHOULD ALWAYS WEAR SAFETY EYE PROTECTION WHEN TOOL IS IN USE.

WHEN THE AIR SUPPLY IS CONNECTED KEEP YOUR HANDS AND BODY AWAY FROM THE FASTENER DISCHARGE AREA.

OPERATING PRESSURE MUST NOT EXCEED 100 PSIG, (6.8 ATMOSPHERES).

DO NOT CONNECT FEMALE QUICK COUPLER DIRECT TO TOOL. ATTACH MALE FREE FLOW NIPPLE TO TOOL, AND FEMALE QUICK COUPLER TO AIR HOSE. IF CONNECTED IMPROPERLY AND DISCONNECTED FROM AIR SUPPLY TOOL WILL REMAIN CHARGED WITH AIR, WILL NOT FREELY EXHAUST AND WILL DRIVE A STAPLE IF TRIGGER MECHANISM IS ACTUATED.

ALWAYS DISCONNECT THE AIR SUPPLY BEFORE MAKING ADJUSTMENTS OR SERVICING THE TOOL.

ALWAYS LOAD WITH NOSE POINTING AWAY FROM YOU.

DO NOT USE OXYGEN OR COMBUSTIBLE GASES AS A POWER SOURCE FOR THIS TOOL.

FAILURE TO OBSERVE ANY OF THESE WARNINGS MAY RESULT IN INJURY.

THESE INSTRUCTIONS ARE INTENDED TO PROVIDE SAFE, TROUBLE-FREE SERVICE FROM YOUR STAPLER. READ THEM CAREFULLY. OPERATORS SHOULD WEAR SAFETY GLASSES OR GOGGLES WHEN OPERATING THIS TOOL. WHEN THE AIR SUPPLY IS CONNECTED KEEP YOUR HANDS AND BODY AWAY FROM THE FASTENER DISCHARGE AREA. ALWAYS DISCONNECT THE AIR SUPPLY BEFORE MAKING ADJUSTMENTS, OR SERVICING THE TOOL. A reasonable amount of care will prevent damage to vital working parts and increase the life of the tool. Do not abuse this tool. A moderate amount of care will give long efficient service.

### AIR SUPPLY AND CONNECTION:

Clean dry air is vital. Air operated tools and equipment need clean, dry, lubricated air for top performance, low maintenance, and long service. The major cause of failure in air operated equipment is dirty, moist, improperly lubricated air!. Failure appears as a slow, continuous deterioration of the tool. Dirt, grit and pipe scale generally present in air line can cause severe abrasive wear in valves and cylinder walls. A filter-Regulator-Lubricator unit is essential and should be installed as close to the tool as possible: preferably within 15 feet (4.6 meters).

Periodic checks should be made to insure the unit is working properly. A dirty filter will result in pressure loss. As dirt accumulates in the filter, the pressure drop increases resulting in lower pressure at the tool and less efficient fastener driving. Fill the lubricator with Mobil Velocite #10 oil, or equivalent. Do not use a detergent oil.

The air supply must be capable of maintaining an air pressure of 50-80 pounds (3.4 - 5.5 atmospheres) per square inch at the tool. **OPERATING PRESSURE MUST NOT EXCEED 100 PSIG (6.8 atmospheres)**. Check the air hose or pipe before attaching it to the filter unit to be sure it is clean.

**DO NOT CONNECT FEMALE QUICK COUPLER DIRECT TO TOOL. ATTACH MALE FREE FLOW NIPPLE TO TOOL, AND FEMALE QUICK COUPLER TO AIR HOSE. IF CONNECTED IMPROPERLY AND DISCONNECTED FROM AIR SUPPLY TOOL WILL REMAIN CHARGED WITH AIR, WILL NOT FREELY EXHAUST AND WILL DRIVE A FASTENER IF TRIGGER MECHANISM IS ACTUATED.**

All hoses, pipes and fittings must have a 3.8" (9.5mm) minimum inside diameter. Hose fittings must have a 9/32" (7.1mm) minimum inside diameter. Air requirements will

# MODEL BCAR1B / BCAR-2S STAPLER

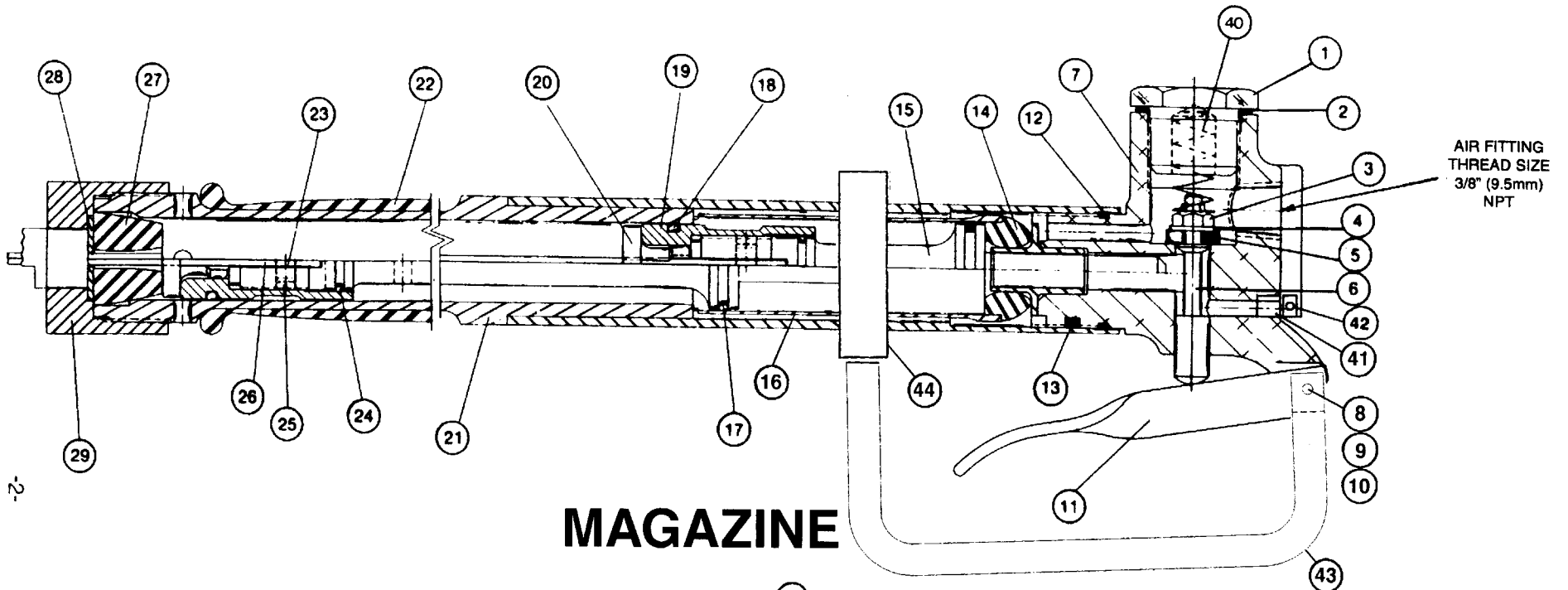

## MAGAZINE

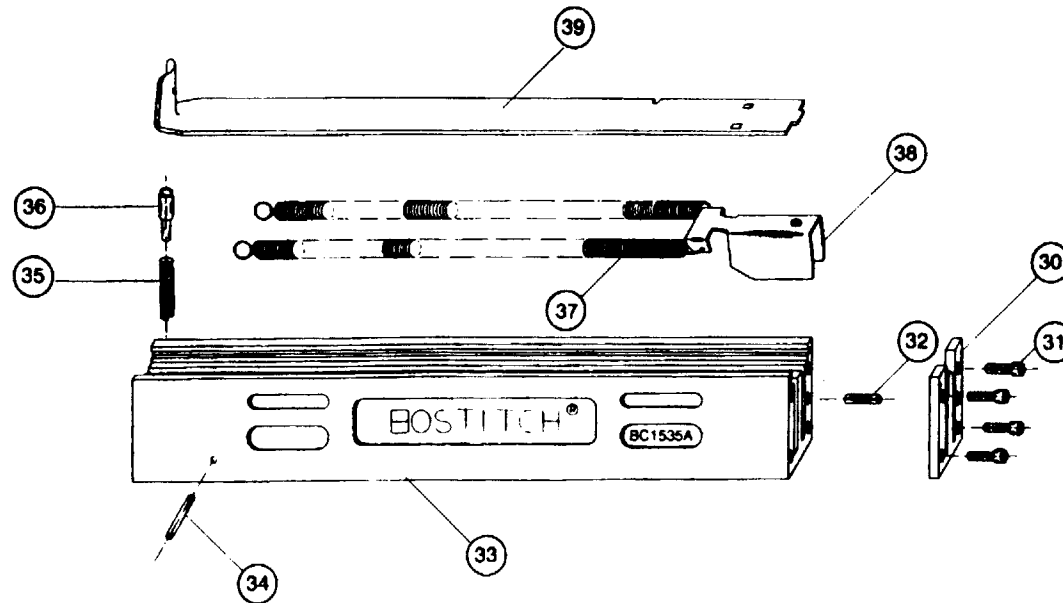

**PARTS LIST FOR MODEL BCAR1B/BCAR-2S STAPLER  
COMMON PARTS**

ITEM NO.	PART NO.	DESCRIPTION	ITEM NO.	PART NO.	DESCRIPTION
1	BC156	VALVE PLUG	17	87137	(UPPER) O-RING
2	105502	VALVE PLUG GASKET	18	88998	(LOWER) O-RING
3	HN1032.5	VALVE STEM NUT	21	BC1527A	CYLINDER ASSEMBLY
4	PW10.5	WASHER	22	H406	HANDLE GRIP
5	BC442	VALVE STEM SEAL	24	86458	STATIC O-RING
6	BC367	VALVE STEM	28	BC1569	BUMPER PLATE
7	BC1602A	VALVE HOUSING	31	UA3816.4	#10-24 X 1" SOC. HD. CAP SCREW
8	UA3820	10-32 X 1-1/4 SHCS	35	BC41	DETENT PIN SPRING
9	PW10.5	WASHER	36	BC34	DETENT PIN
10	HN1032.5	10-32 ELASTIC STOP NUT	40	T36135	VALVE SPRING
11	BC283	TRIGGER (LONG)	41	BC1601	MUFFLER
12	88705	STATIC O-RING	42	UB1110	SPIROL PIN (1/16 X 5/8)
13	BC347	NYLON RETAINING PLUG (VALVE HOUSING)	43	108800	HANDLE, TRIGGER GUARD
14	BC1474	RETURN BUMPER	44	108801	COLLAR, TRIGGER GUARD
16	BC1530	CYLINDER SLEEVE			

**VARIABLE PARTS**

MODEL NUMBER	STAPLE			ITEM NUMBER														
	TYPE	WIRE GAUGE	MAX. LEG LENGTH	15	19	20	23	25	26	27	29	30	32	33	34	37	38	39
				UPPER PISTON	LOWER PISTON	PISTON PLUG	DRIVER PIN	NYLON INSERT	DRIVER BLADE	DRIVER BUMPER	NOSE ASS'Y	WEAR PLATE	PIN	MAGAZINE ASS'Y	PIN	PUSHER SPRING	PUSHER	MAGAZINE COVER
BCAR1B-S4	S4	16 1.6mm	1-3/4"	BC1583	BC1570	BC1571	BC1584	BC347	BC1573	BC1572	BC1575A	BC731		BC730A	UB2822	BC196	BC689	BC690
BCAR1B-495-92L	158	16 1.6mm	3/4"	BC1529	BC1477	BC1479	BC1478	T34233	BC1531	BC1481	BC1532A	BC1547* BC1545	UB2808.2	BC1535A	UB2820	BC1260	BC694	BC1537
BCAR-2S**	158	16 1.6mm	3/4"	BC1529	BC1477	101608	BC1478	T34233	100828	BC1572	100346	BC1547* BC1545	UB2808.2	BC1535A	UB2802	BC1260	BC694	BC1537

\* Supplied with tool separately as an accessory. Wearplate is for 1" max. leg length.

\*\*Model BCAR-2S drives two type 158 staples simultaneously.

vary with the type of material to be fastened, and the operating speed. Do not use more air pressure than required for the job. Air pressure in excess of the amount required to provide adequate fastening, wastes compressed air and may result in damage to equipment.

For best results the air pressure can be determined by driving a few fasteners into the work and adjusting the air pressure until the staple crown is driven down to the work. Excessive air pressure may cause the staple crown to cut the material.

After all air connections are made, check to be sure they are tight to prevent air loss, and insure best performance.

#### TO LOAD:

**▲WARNING:** ALWAYS LOAD WITH NOSE POINTING AWAY FROM YOU.

Pull cover back until locked by detent pin. Insert stick of fasteners and push forward into channel. Then push cover forward until locked by detent pin. The tool is now ready to operate.

#### OPERATION:

Do not attempt to operate the tool without fasteners, or drive fasteners into the air, as the life of the tool will be reduced, plus the danger involved by driving fasteners into the air. Hold the tool with a firm grip on the rubber handle, and on cylinder assembly below the valve housing. Place the tool over the location where the fastener is required and pull the trigger.

#### MAINTENANCE:

**▲WARNING:** DISCONNECT THE AIR SUPPLY BEFORE SERVICING THE TOOL.

When ordering replacement parts, be sure to specify the part number. Do not order by item number or description: order only by part number. Do not wrench, twist or force any parts during servicing, as damage may result from such abuse.

Be sure all screws are checked periodically for tightness. Observe caution against stripping threads when tightening screws.

If the stapler is disassembled for replacement of parts, clean and remove particles of grit and dirt. Lubricate all moving parts after cleaning. Apply Parker "O" Lube to all O-rings. Examine all parts for wear during servicing so that replacement parts can be ordered in advance of trouble.

**IMPORTANT: A PERIODIC CHECK SHOULD BE MADE OF THE DRIVE BUMPER, RETURN BUMPER, AND THE PISTON PLUG. A WORN BUMPER SHOULD BE REPLACED BEFORE DAMAGE CAN OCCUR TO THE RELATED PARTS. IF THE DRIVE BUMPER OR PISTON PLUG IS SEVERELY CHIPPED IT SHOULD BE REPLACED IMMEDIATELY. CHECK FOR AIR LEAKAGE ABOUT RETURN BUMPER. REPLACE IF NECESSARY.**

The machine should be cleaned periodically like all tools which are subjected to dirt and grit.

**NOTE: FOR BEST RESULTS, WHEN REASSEMBLING VALVE HOUSING ASSEMBLY TO CYLINDER, TIGHTEN VALVE HOUSING UNTIL CONTACT IS MADE WITH TOP OF CYLINDER. BACK OFF VALVE HOUSING UNTIL TRIGGER IS CONVENIENTLY LOCATED, PREFERABLY TO THE REAR OF THE MACHINE.**

When servicing the tool, be sure to replace the bumpers, piston plug and O-rings. Omission of these parts will result in serious damage or air leakage.

#### LUBRICATION:

Use Mobil Velocite #10 oil, or equivalent, for all normal conditions. Do not use detergent oil. Tools which are in constant operation should be lubricated daily with a reasonable amount of oil. Lubricate regularly instead of excessively.

#### FILTER-REGULATOR-LUBRICATOR:

See manufacturer's instructions for maintenance of this unit. It should be thoroughly cleaned periodically for best results. Dirt in air lines may damage precision cylinders and clog valves.

#### RESPONSIBILITY FOR EYE PROTECTION:

Because this tool can cause flying fasteners or debris, safety eye protection is necessary for both users of the tool and those in the immediate working area. Employers and purchasers of this tool are in the best position to ensure that these persons use eye protection.

**▲WARNING:** EYE PROTECTION which conforms to ANSI specifications and provides protection against flying particles both from the FRONT and SIDE should ALWAYS be worn by the operator and others in the work area when loading, operating or servicing this tool. Eye protection is required to guard against flying fasteners and debris, which could cause severe eye injury.

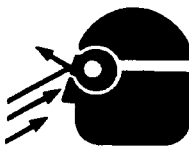

The employer and/or user must ensure that proper eye protection is worn. Eye protection equipment must conform to the requirements of the American National Standards Institute, ANSI Z87.1-1989 and provide both frontal and side protection. NOTE: Non-side shielded spectacles and face shields alone do not provide adequate protection.

**BOSTITCH**

Stanley Fastening Systems®

East Greenwich, RI 02818 U.S.A.