

RTP series - ROTARY CYLINDER

Operating specification and Ordering expression

CHELIC PNEUMATIC

Internal structure

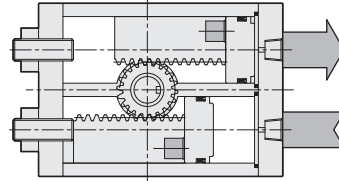
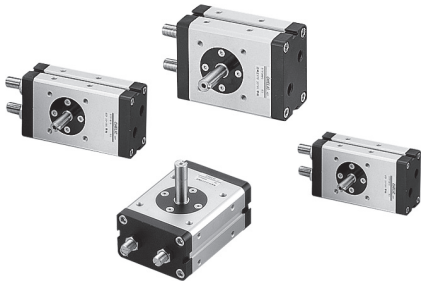

Specification

Item	Model	RTP5 - □	RTP10 - □	RTP20 - □	RTP30 - □
Operation		Double acting			
Fluid		Air			
Torque	N·m	0.38	0.88	1.86	2.94
Bore size		Ø16	Ø20	Ø25	Ø30
Rotation angle		90° ~ 180°			
Adjustment angle		+5° ~ -30°			
Prot size		Rc1/8"			
Pressure range	kgf/cm ² (kpa)	1.5~7(150~700)			
Temperature range	°C	0~50			

RTM
Rotary
Cylinder

RTB
Rotary
Cylinder

RTBM
Rotary
Cylinder

RTZB
Rotary
Cylinder

RTP
Rotary
Cylinder

RTH
Rotary
Cylinder

RTU
Hydraulic
Cylinder

Rotation angle and Rotation range

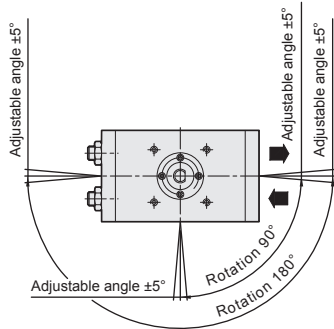

Output characteristics

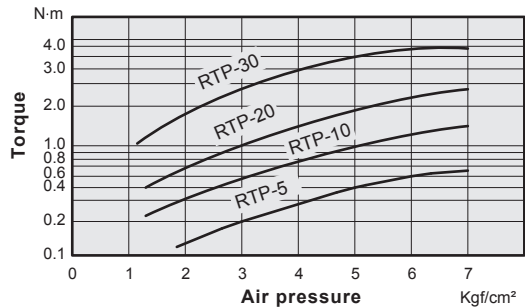

How to order

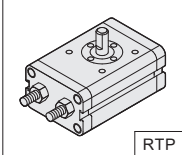
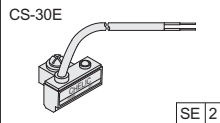
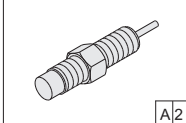
RTP	10	×	180	-	2	D	-	SE	2	-	A	2
Model	Torque		Rotation angle		Axis type			Sensor switch			Shock absorber	
	5 : 0.38 N·m 10 : 0.88 N·m 20 : 1.86 N·m 30 : 2.94 N·m		90 - 90° 180 - 180°		None : Single rod 2D : Double rod							

[SE] : Sensor code (CS-30E) A : Shock absorber
 [SEN] : Sensor code (CS-30EN) 1 = 1 PCS
 [SEP] : Sensor code (CS-30EP) 2 = 2 PCS (option)
 [2] : Number of sensor
 1 = 1 PCS
 2 = 2 PCS

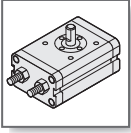

RTP series - ROTARY CYLINDER

Components and Material list

CHELIC PNEUMATIC

Internal structure

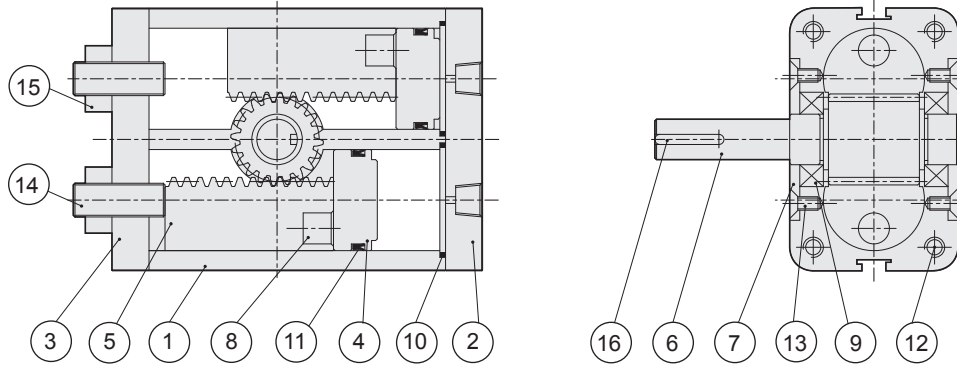

Components and Material list

No.	Item	Material	No.	Item	Material
01	Body	Aluminum alloy	09	Bearing	Bearing stell
02	Front cover	Aluminum alloy	10	Head cover gasket	NBR
03	End cover	Aluminum alloy	11	Piston packing	NBR
04	Piston	Teflon	12	Hexagon screw	Alloy steel
05	Rock	Plastic steel	13	Rod cover screw	Alloy steel
06	Gear shaft	Medium carbon steel	14	Stopper bolt	Alloy steel
07	Rod cover	Aluminum alloy	15	Nut	Medium carbon steel
08	Magnet	Rare earth metals	16	Key	Medium carbon steel

Packing and O-Ring list

Item	Piston packing	Head cover gasket
Number	2	2
Bore size(mm)		
Ø16	DYP - 16	16.8 x 1.3
Ø20	DYP - 20	20 x 1.6
Ø25	DYP - 25	25.7 x 1.78
Ø30	DYP - 30	30 x 2

Weight table

Item	Weight (g)	
	90°	180°
Bore size (mm)		
RTP Ø16	320	377
RTP Ø20	426	519
RTP Ø25	665	803
RTP Ø30	1068	1462

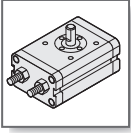

RTP series - ROTARY CYLINDER

Mounting type and External dimensions

CHELIC PNEUMATIC

Mounting type

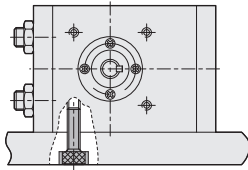

● Side mounting

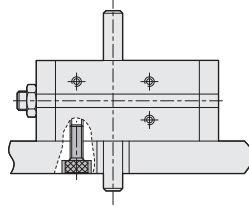

● Bottom mounting

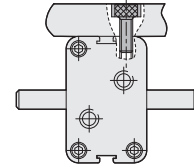

● Top mounting

External dimension

● RTP-5 Axis type

● RTP10~30 Axis type

● The groove of sensor switch

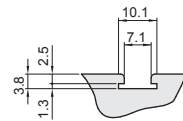
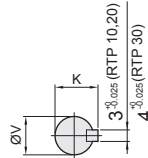
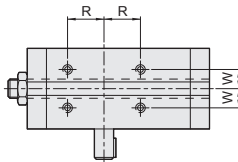

● One axis type (Standard)

● Both axis type (2D)

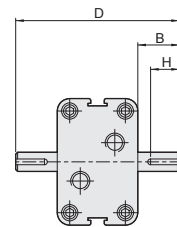
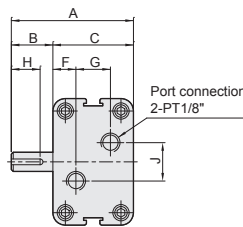
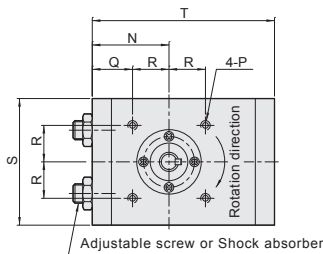

Model	A	B	C	D	F	G	H	J	K	N	P	Q	R	S	T	V	W
RTP5 - 90°	52	20	32	72	11	10	10	16	5.5	30.5	M5x0.8P,dp 7	14.5	16 ^{±0.1}	52	70	6 ^{h7}	8
RTP5 - 180°										35.5		19.5			86		
RTP10 - 90°	61	25	36	86	11	14	19	14	9.2	34.5	M5x0.8P,dp 7	17.5	17 ^{±0.1}	56	81	8 ^{h7}	9
RTP10 - 180°										44		27			103		
RTP20 - 90°	72	30	42	102	12	18	19	20	11.2	40	M5x0.8P,dp 7	21	19 ^{±0.1}	66	94	10 ^{h7}	10
RTP20 - 180°										52		33			120		
RTP30 - 90°	90	40	50	130	12	26	19	36	13.2	50	M6x1.0P,dp 8	22	28 ^{±0.1}	78	110	12 ^{h7}	15
RTP30 - 180°										71		43			150		

RTM
Rotary
Cylinder

RTB
Rotary
Cylinder

RTBM
Rotary
Cylinder

RTZB
Rotary
Cylinder

RTP
Rotary
Cylinder

RTH
Rotary
Cylinder

RTU
Hydraulic
Cylinder

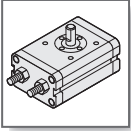

RTP series - ROTARY CYLINDER

Accessories and Material table

CHELIC PNEUMATIC

▶ Sensor switch installation

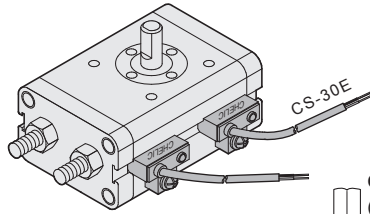

CS-30E
(Please refer to P3-12-3 formula for sensor switch)

● RTP type

▶ Setting and Operating of sensor switch

● CS - 30E

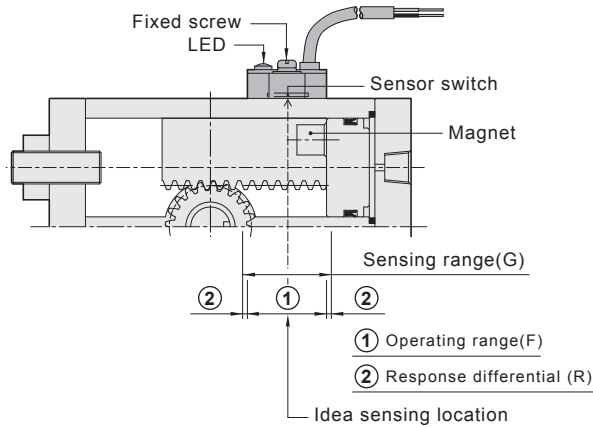

▶ Sensing range

Sensor switch is fixed on the cylinder body.
The magnetic piston head will activate the sensor switch when it enters the operating range.

Unit : mm

Model	CS-30E , CS-30EN(P)	
Bore size	Operating range (F)	Response differential(R)
RTP-5	10	1.5
RTP-10	8.5	1.0
RTP-20	7	1.0
RTP-30	8.5	1.0

▶ Operating range

When piston head moves the switch setting and adjustment will be based on the responding range generated by the magnetic field and the switch. (Please refer to the right table)

▶ Connection type

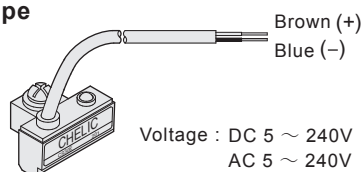

CS-30E

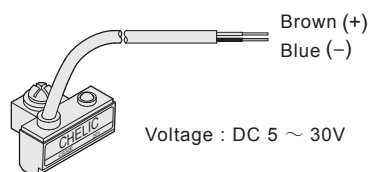

CS-30EN(P)