



Introduction

This "Operating and maintenance manual" is an essential and integral part of the machine and must be readily available to operating and servicing personnel.

The owner, operator and maintenance Manager must be familiar with the contents of this manual, which is based on a simple model of NS 5820 *Supplier's documentation of equipment.*

General data

Type	: Level indicator
Description	: Level indicator with rotating paddle
Use	: For materials having a density from 0,5 to 2 t/m ³
Improper use	: ILC level indicators are not designed to work in dangerous conditions or with dangerous materials. (ex. Explosives, toxics)
Temperature	: -20 to +80 °C

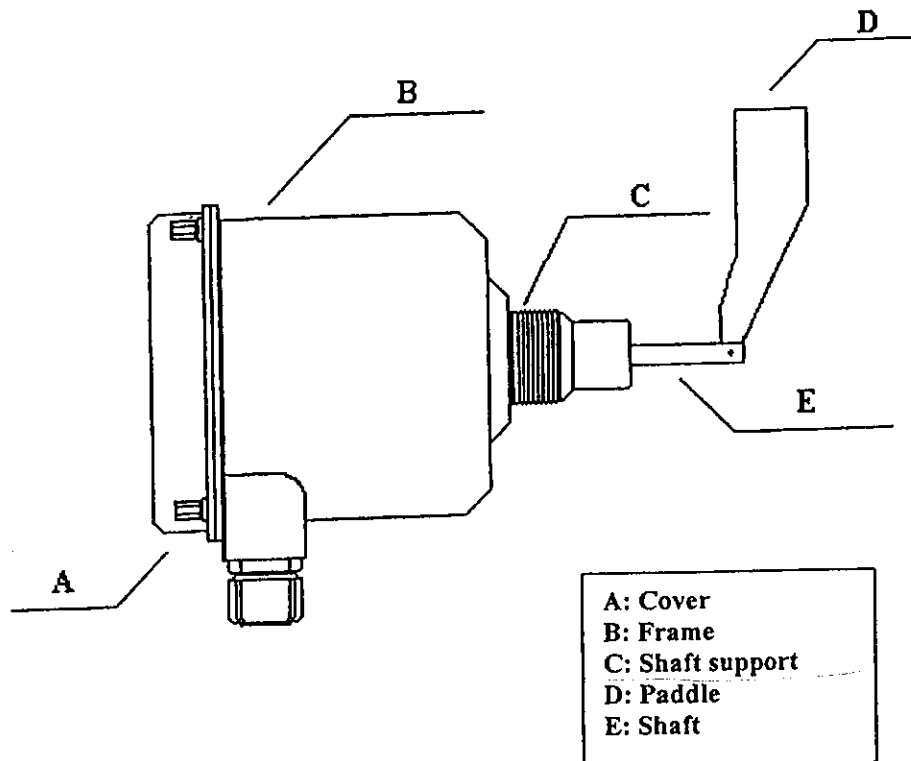

Dimensions

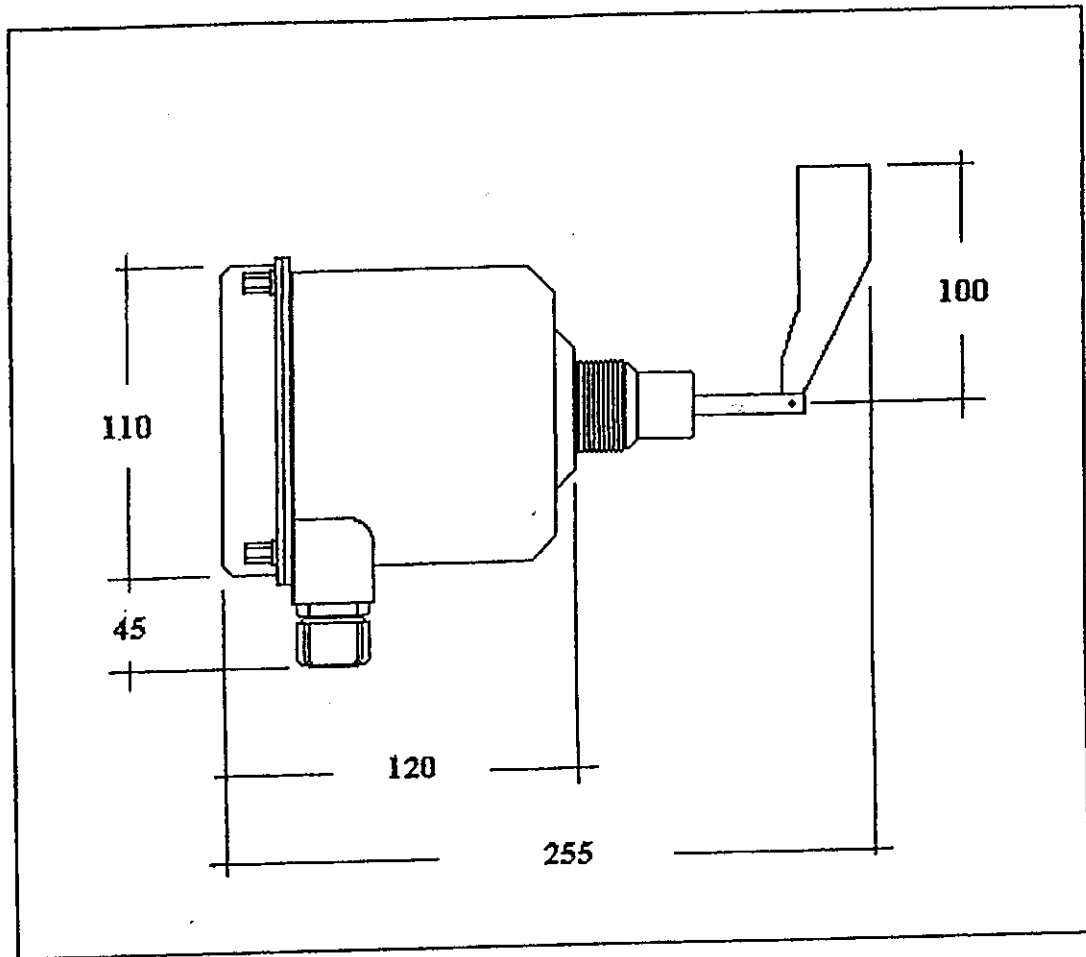

Connections

Electrical connection

Take note of the power indicated on the legend plate.

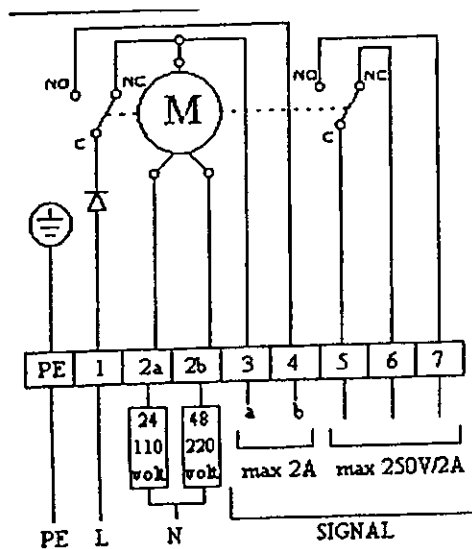

Commissioning testing

Before starting, check the electrical connections and the right installation.
To facilitate the operation we repeat briefly the checks to do.:L

1. Read completely this manual
2. Check the right connection of the Machine
3. Check the right electrical connections and the perfect closure of the cover.

Maintenance

Before carrying out any type of work on the machine, stop it and disconnect it from all electric supply sources.

N.B. : Failure to observe these instructions can cause problems and make the warranty null and void.

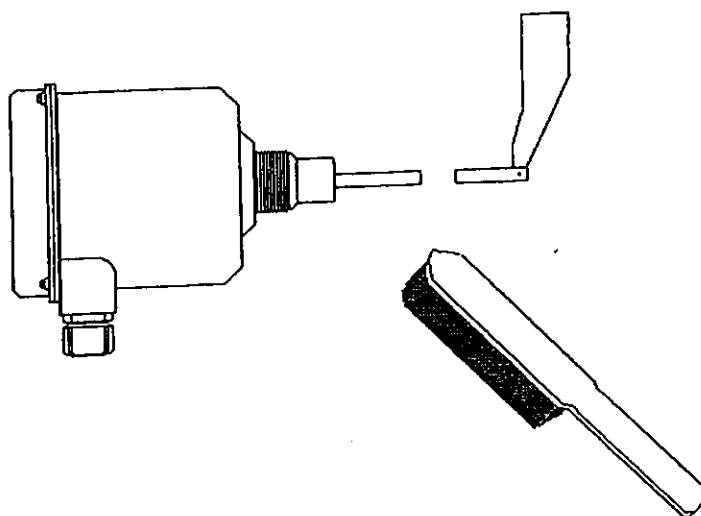

BUILD UP REMOVAL

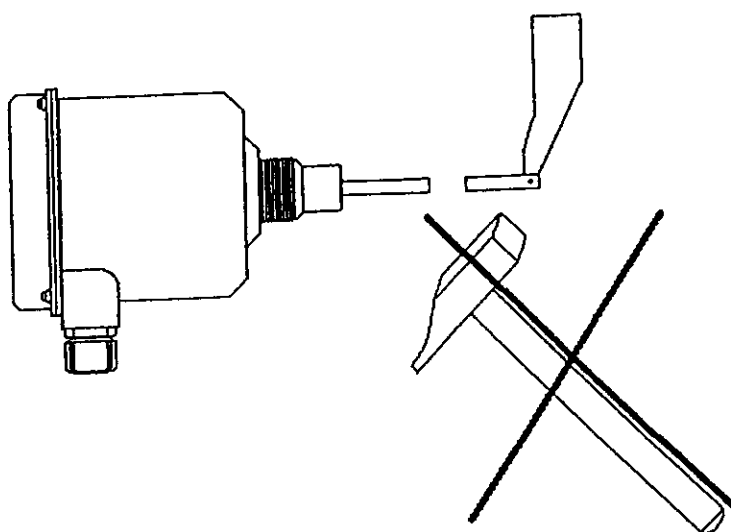



Dismantling

To scrap:

When the level indicator's working life ends, remove the plastic parts (seal rings) and take them to specialised disposal centres. The remaining components can be sent to metal salvage centres.

When scrapping the level indicator, bear in mind, the different kinds of material used to fabricated it.

Safety

The level indicator must not be used even partially by unauthorised personnel.

The shop foreman or Department Manager is responsible for Machine operator training and for checking training level achieved.

Read carefully the warning notices attached to the machine.

When the level indicator is running, do not service, regulate the machine or carry out any other operation not strictly required by the work cycle. Before any of the above listed operations, always disconnect the machine for all electric power supply sources.

All service, lubrication and cleaning jobs should only be performed when the machine is stopped and switched off the electrical main voltage. Service should only be done by qualified personnel.

Never insert hands or tools into openings with rotating parts.

Any repair, service or maintenance work, whether electrical or otherwise, must be compliance with CEI standards 64.8 462.2 463.1 573.3

Spare parts list

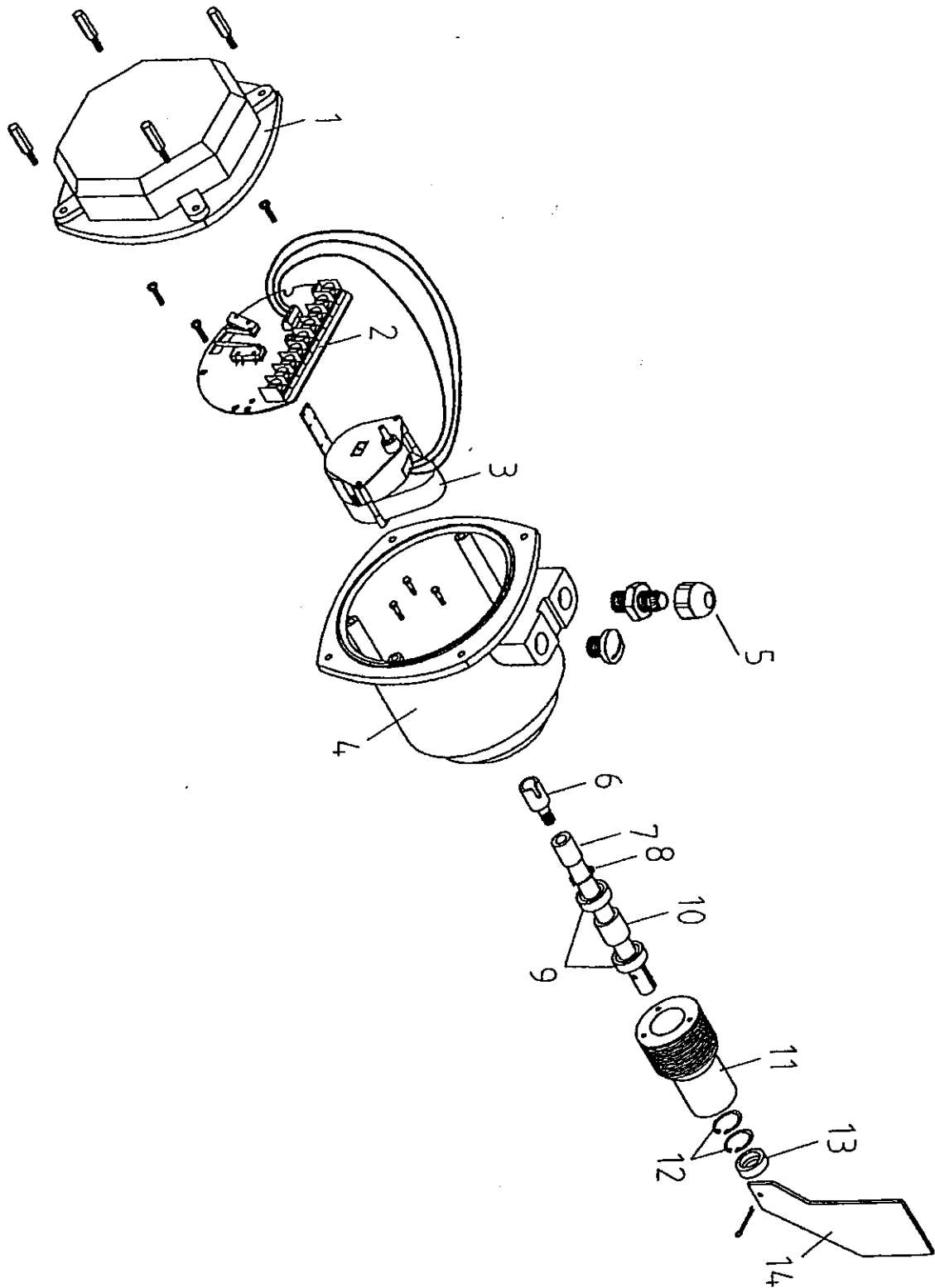



Assembly drawing for rack;

Pos. no.	Description	Code
01	Cover	20930501 A
02	Electronic control card	3830001000
03	Electric motor 24 V	3850SA0090
03	Electric motor 48 V	3850SA0095
03	Electric motor 110 / 220 V	3850SA0100
04	Frame	20900501 A
05	Packing gland	3804CA0050
06	Bush	30987501 A
07	Shaft	20950501 A
08	Snap ring 10	DIN471
09	Bearing 6000-z	3604ZK0061
10	Bush	20979501 A
11	Shaft-support 1 ¼"	20974401 A
11	Shaft-support 1 ½"	20974501 A
11	Shaft-support 2 ½"	20974601 A ✓
12	Snap ring 26	DIN 472
13	Oil seal type 10 26 7	2502FP0700
14	Paddle	20731502 A