

ZB2-●●●● & PXB-B19●● & PXB-B29●●

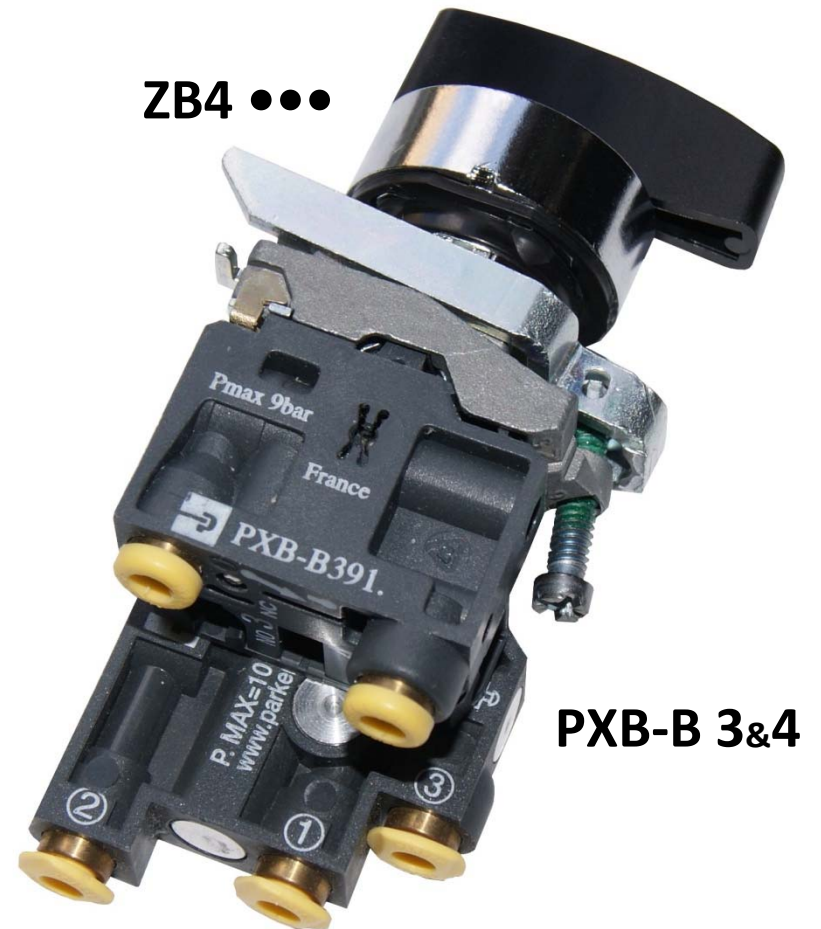

DISCONTINUED



ZB2-xxxxx & PXB-B191• & PXB-B291• DISCONTINUED



- The new VALVE version is not compatible with the old mounting block ZB2-BZ009 → it is necessary to replace it by ZB4-BZ009
- The new operating HEAD version is not compatible with the old mounting block ZB2-BZ009 → it is necessary to replace it by ZB4-BZ009

To replace old ZB2 operating HEAD or old valve PXB-1 or 2 fitted on the old ZB2-BZ009 mounting block it is necessary to replace the 3 parts : operating HEAD + mounting BLOCK + VALVE by the new version



PXB-B 3 & 4

ZB4-B...



ZB2-BZ009

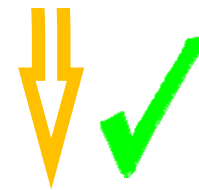

ZB4-BZ009



ZB2-BZ009



Ø 4 mm instant straight connections

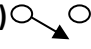
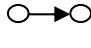

PXB-B19●●	Old version	New version
Normally non passing (NNP) 	PXB-B1911	PXB-B3911
Normally passing (NP) 	PXB-B1921	PXB-B3921

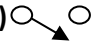
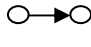

PXB-B29●●	Old version	New version
Normally non passing (NNP) 	PXB-B2911	PXB-B4931 *
Normally passing (NP) 	PXB-B2921	PXB-B4931 *



* as the PXB-B4931 is composed by (x1) NNP & (x1) NP

→ the alternative for PXB-B2911 or PXB-B2921 is the same part number : PXB-B4931

M5 thread connections

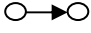

PXB-B19●●	Old version	New version
Normally non passing (NNP) 	PXB-B1915	PXB-B3915
Normally passing (NP) 	PXB-B1925	PXB-B3925

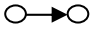

PXB-B29●●	Old version	New version
Normally non passing (NNP) 	PXB-B2911	PXB-B4935 *
Normally passing (NP) 	PXB-B2921	PXB-B4935 *



* as the PXB-B4935 is composed by (x1) NNP & (x1) NP

➔ the alternative for PXB-B2911 or PXB-B2921 is the same part number : PXB-B4935

Ø 6 mm instant straight connections

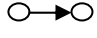

PXB-B19●●	Old version	New version
Normally non passing (NNP) 	PXB-B1916	PXB-B3915 **
Normally passing (NP) 	PXB-B1926	PXB-B3925 **

+ (x2)

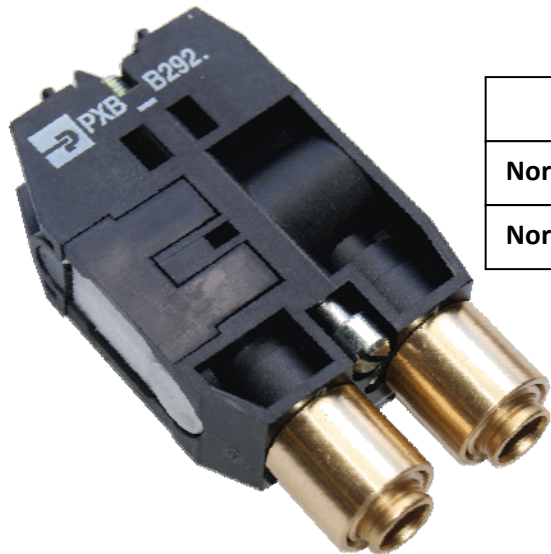

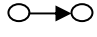
PXB-B29●●	Old version	New version
Normally non passing (NNP) 	PXB-B2911	PXB-B4935 * **
Normally passing (NP) 	PXB-B2921	PXB-B4935 * **

+ (x3)

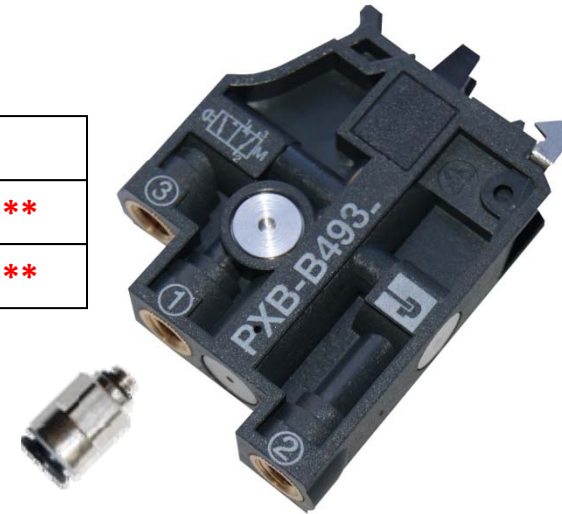

* as the PXB-B4935 is composed by (x1) NNP & (x1) NP

➔ the alternative for PXB-B2911 or PXB-B2921 is the same part number : PXB-B4935

** as there is not a Ø 6 mm instant straight connections in the new version, the suggested alternative is with M5 thread connections + (x2 or x3) male connector M5/ Ø 6 mm instant straight connections

Ø 4 mm instant swivel connections

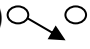
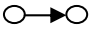

PXB-B19●●	Old version	New version
Normally non passing (NNP) 	PXB-B1912	PXB-B3912
Normally passing (NP) 	PXB-B1922	PXB-B3922

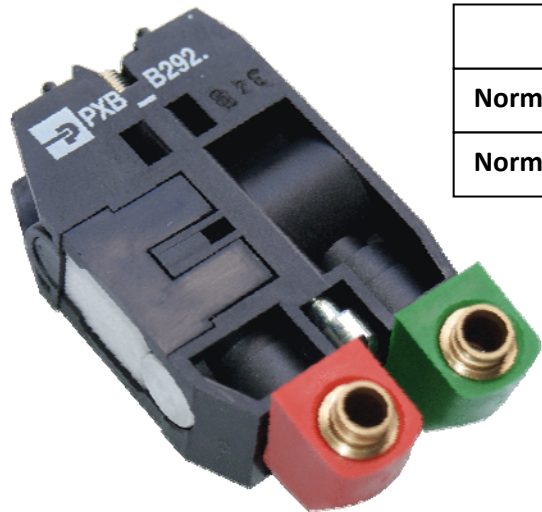

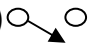
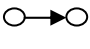
PXB-B29●●	Old version	New version
Normally non passing (NNP) 	PXB-B2912	PXB-B4932 *
Normally passing (NP) 	PXB-B2922	PXB-B4932 *

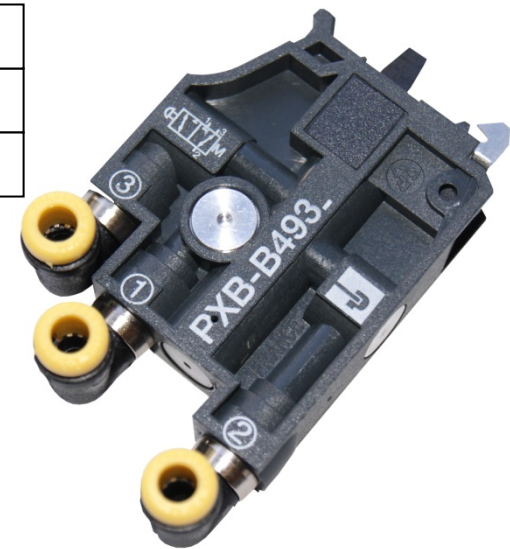

* as the PXB-B4932 is composed by (x1) NNP & (x1) NP

➔ the alternative for PXB-B2911 or PXB-B2921 is the same part number : PXB-B4932

Electrical switch & Mounting block



		Old version	New version
Normally Open (NO)		ZB2-BE101	ZBE-101
Normally Closed (NC)		ZB2-BE102	ZBE-102

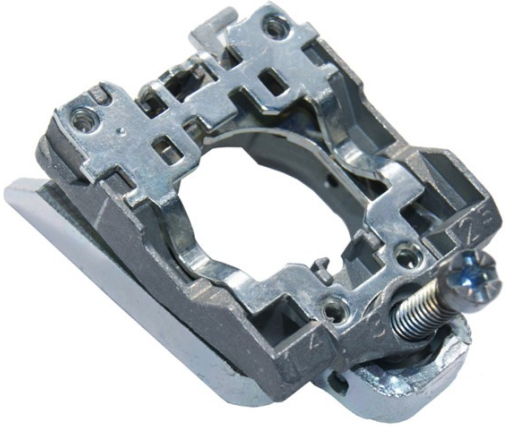

Old version	New version
ZB2-BZ009	ZB4-BZ009

ZB4 ••• Robustness & Safety



Single fixing screw

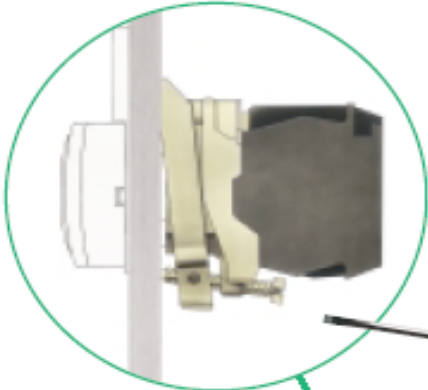

- Self-locking, vibration resistant and 3 point fixing
- Automatic earthing

functions

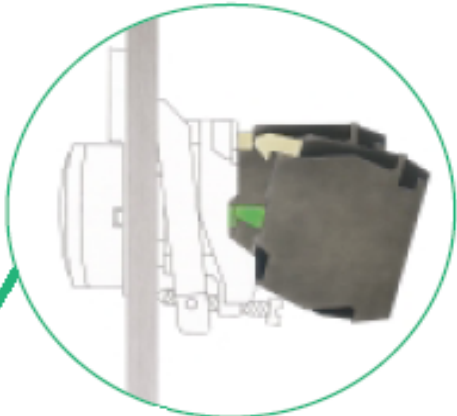

Simple clip-on mounting for contact blocks
Fast reliable, no tools required

Head to body assembly

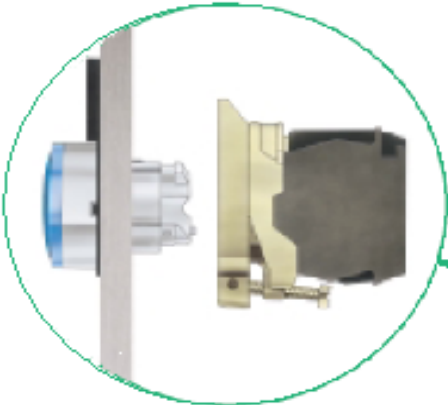

- Head automatically retains its position within cut-out
- Body/fixing collar clips onto head

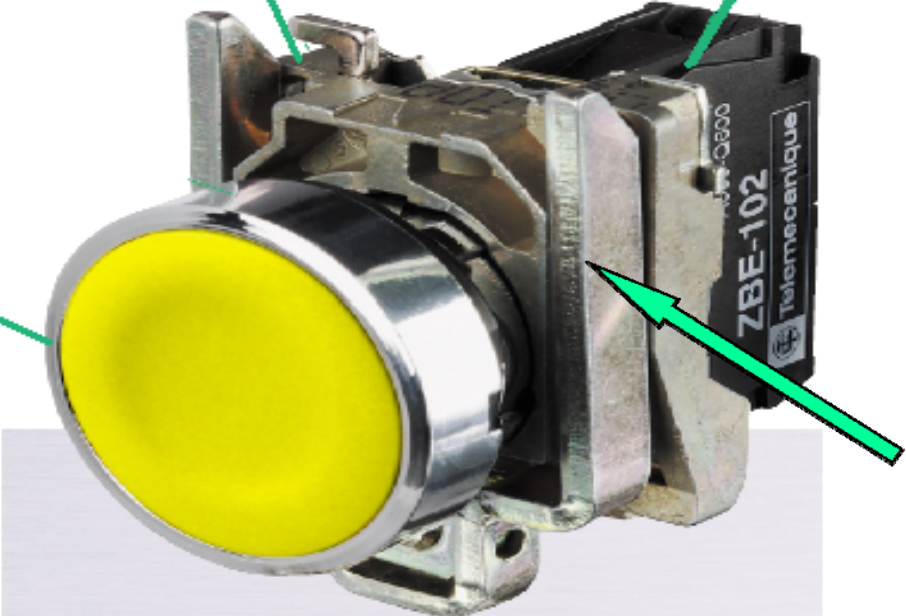

Metal latch

ZB4 ••• Assembled in "One Click"!

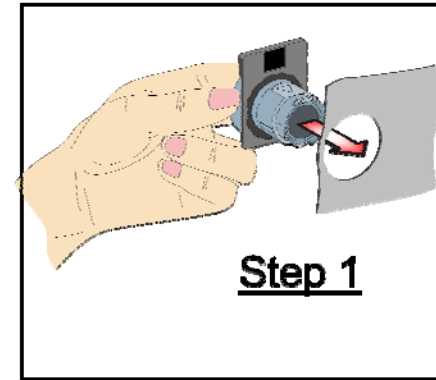
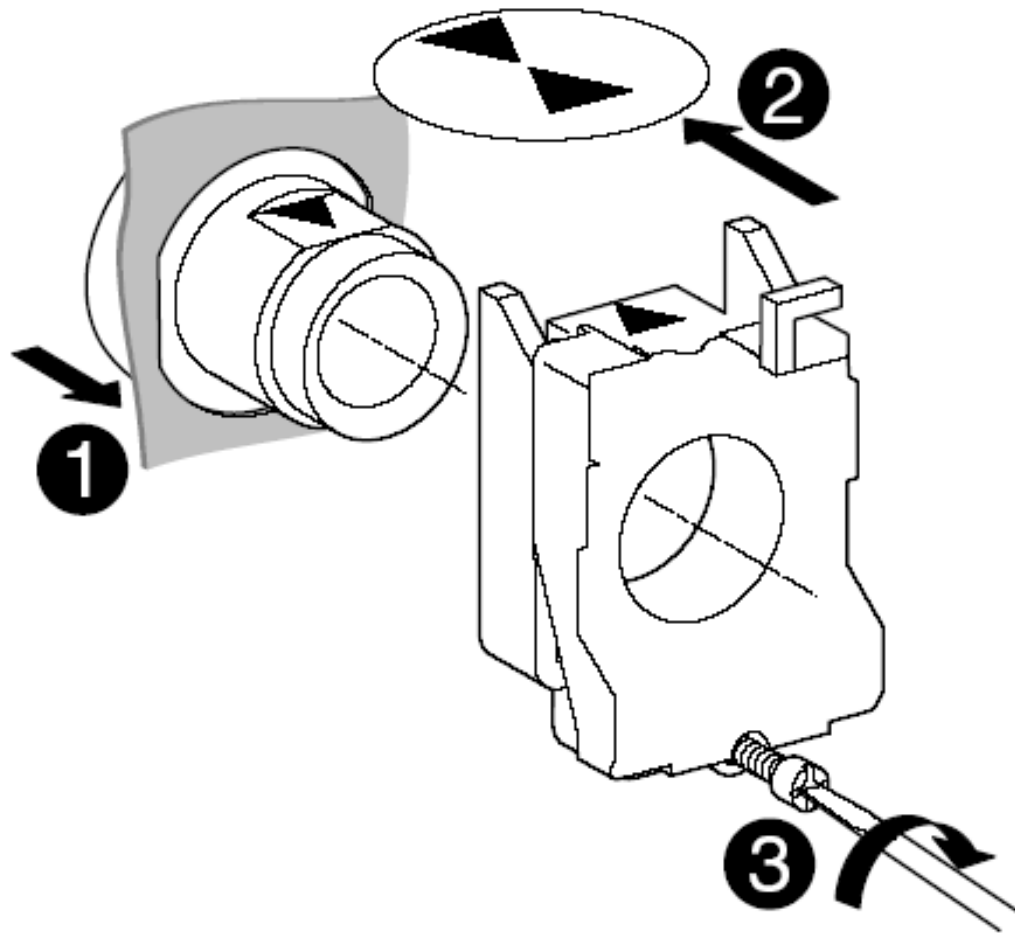

Step 1

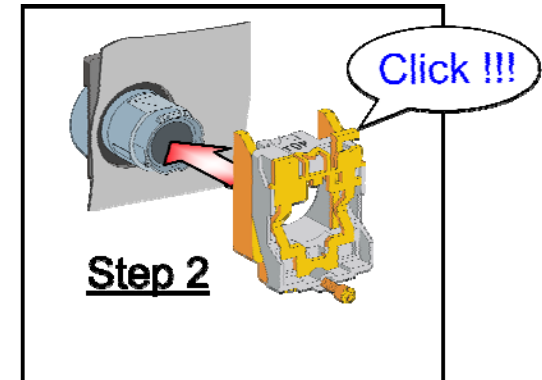

Step 2

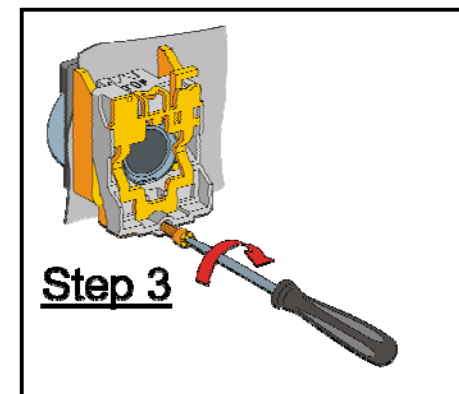

Step 3

0,8 Nm/7.5 lb-in (maxi 1,2 Nm/10.6 lb-in)

