

# AIR EXHAUST MUFFLER SERIES B, M and N



## Description:

“The Original“...provides up to 85% noise reduction and 94% flow factor

Thoroughly proven on thousands of installations, the world-class Atomuffler Air Exhaust Muffler expertly reduces Exponentially Perceived Noise (PNdB) without impeding equipment performance. Its design takes explosive air exhaust noise discharged from valve exhaust ports and muffles it with optimized Sonstant Velocity (CV) flow factor. Exhaust air flows softly to atmosphere free of noise, oil fog and contaminates – providing a clean, comfortable and productive work environment.

The Air Exhaust Muffler features a unique obstruction-free expansion chamber. Standard Air Exhaust Muffler construction includes aluminium end covers, zinc-plated steel components and a cellulose fiber element.

This design is recommended for general purpose air exhaust applications for pressures up to 125 psi.

# AIR EXHAUST MUFFLER SERIES B, M and N

Sample for Type Key: **B05-0121005**

Model Type \_\_\_\_\_  
 Item Number \_\_\_\_\_  
 Conn. Size \_\_\_\_\_

| Connection Thread Types |           |             |          |             |            |             |                     |            |          |     |     |
|-------------------------|-----------|-------------|----------|-------------|------------|-------------|---------------------|------------|----------|-----|-----|
| Conn. Size<br>A         | Male BSPT |             | Male NPT |             | Female NPS |             | Replacement Element | Dimensions |          |     |     |
|                         | Type      | Item Number | Type     | Item Number | Type       | Item Number |                     | B Male     | B Female | C   | D   |
| 1/8"                    | B01       | 0121001     | M01      | 0111001     | N01        | 0211001     | 0911001             | 80         | 72       | 47  |     |
| 1/4"                    | B02       | 0121002     | M02      | 0111002     | N02        | 0211002     | 0911002             | 111        | 102      | 47  |     |
| 3/8"                    | B00       | 0121000     | M00      | 0111000     | N00        | 0211000     | 0911000             | 130        | 116      | 66  |     |
| 1/2"                    | B05       | 0121005     | M05      | 0111005     | N05        | 0211005     | 0911005             | 153        | 140      | 80  |     |
| 3/4"                    | B07       | 0121007     | M07      | 0111007     | N07        | 0211007     | 0911007             | 183        | 170      | 87  |     |
| 1"                      | B10       | 0121010     | M10      | 0111010     | N10        | 0211010     | 0911010             | 223        | 202      | 100 |     |
| 1 1/4"                  | B12       | 0121012     | M12      | 0111012     | N12        | 0211012     | 0911012             | 223        | 204      | 100 |     |
| 1 1/2"                  | B15       | 0121015     | M15      | 0111015     | N15        | 0211015     | 0911015             | 345        | 318      | 134 |     |
| 2"                      | B20       | 0121020     | M20      | 0111020     | N20        | 0211020     | 0911020             | 480        | 17.75    | 134 |     |
| 3"                      | B30       | 0121030     | M30      | 0111030     |            |             | 0911030             | 582        |          | 210 | 175 |
| 4"                      | B40       | 0121040     | M40      | 0111040     |            |             | 0911040             | 598        |          | 238 | 199 |
| 6"                      | B60       | 0121060     | M60      | 0111060     |            |             | 0911060             | 786        |          | 334 | 278 |

## Measures:

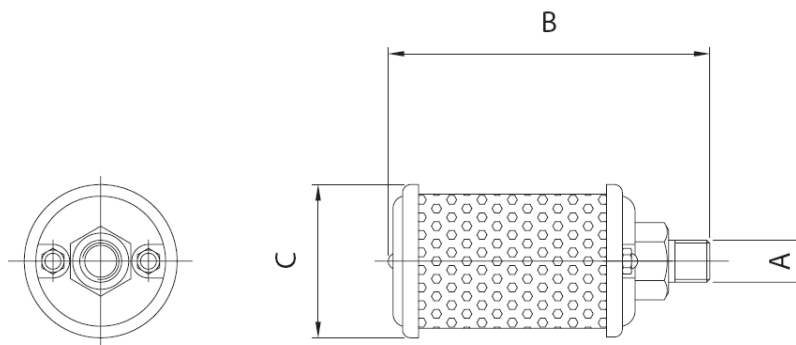

Type up to 2"

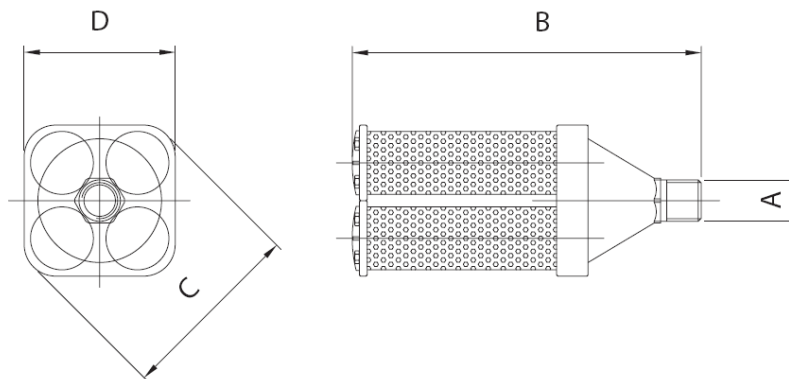

Type at 3"

# AIR EXHAUST MUFFLER SERIES B, M and N



## Technical Data:

|                            |                |
|----------------------------|----------------|
| max. operating pressure    | 10 bar/150 psi |
| max. operating temperature | 160°C          |
| attenuation EPNdB          | 17-22 dBA      |
| noise reduction            | 80-92%         |
| flow factor                | 94%            |
| filtration sound absorber  | 10 µm          |

## Bill of Materials:

|                            |                     |
|----------------------------|---------------------|
| port cover                 | H.T. cast aluminium |
| lock nuts                  | steel zinc plated   |
| Steel zinc plated          | steel zinc plated   |
| resonator disc (from 3/4") | stainless steel 409 |
| tie rods                   | steel zinc plated   |
| perforated sheet           | stainless steel 409 |
| sound absorber             | cellulose fiber     |
| back cover                 | H.T. cast aluminium |

## Maintenance:

Only maintenance activity is change of filter element, interval isn't specified. Indication for change element can be apply of pressure relief valve.

## Mounting Instructions:

All units are provided with a hex head, making them easy to attach to exhaust ports. Units should be mounted in a protective position, free from excess vibration.

Details and illustrations are non-binding, subject to change without notice.